

PL-900RG-N FEATURES



Amphenol Alden's **Pulse-Lok®** 900RG-N Series offering of 52 contacts in a medium sized connector allows for a cost effective solution for a high number of contact terminations.

Overview (intuitive, compact, configurable) Order as a full cable assembly (Consult Factory)

- **Pulse-Lok®** auto-latch / mating confirmation
- 0.900" diameter circular shell
- 6 color options in a variety of combinations
- Multiple standard and proprietary keying options
- Up to 52 contact positions
- Single or double ended
- Customize your cable bundle
- Overmolded strain relief
- Add components to fulfill design requirements

SPECIFICATIONS

Material

Connector Housing: Polyamide 12 (LV3H)
Molded Core Insulator: Polyamide 46
Contacts: Brass / Phosphor Bronze
• 30µ" Gold over 50µ" Nickel
Flammability Rating
• Housing & Coupler: 94HB
• Molded Contact Insulator (core): UL94 V-0

Mechanical

Mating Cycles: 5,000
Mating Force:
• Mate: 13.5 lbs. Max
• Un-mate: 3.0 lbs. Max
• Unintended extraction: 70 lbs. Min.
• Backshell Withdrawal: 9.5lbs. Min.***

Environmental

- Operating Temp: -20C to +85C**
- Moisture Resistance: to IP-67 (mated)
- Sterilizable: EtO**
- Chem. Resistance: common OR cleaning solvents

**Consult factory for other sterilizability options

***Backshell sold separately

TABLE A:

STANDARD CONTACT CONFIGURATIONS & SPECIFICATIONS

Number of Poles	Contact Size Pin ϕ (mm)	Max Wire Gauge	Operating Voltage Max	Operating Current Max (A)*	Mated Contact Resistance (m Ω)
52	0.5	26	300 V RMS	1.5	<50
41	0.5	22	300 V RMS	2.0	<50
35	0.5	26	300 V RMS	1.5	<50
28	0.5	26	300 V RMS	1.5	<50
24	0.5	26	300 V RMS	1.5	<50
24	0.7	22	300 V RMS	2.0	<50
17	0.5	26	300 V RMS	1.5	<50
15	0.7	22	300 V RMS	2.0	<50
11	0.5	26	300 V RMS	1.5	<50
9	0.7	22	300 V RMS	2.0	<50

*30C Heat Rise Limit

Up to 52 Contact Positions

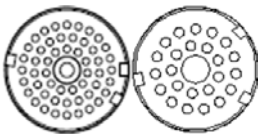

Custom contact inserts are available. Consult factory.

STANDARD HOUSING OPTIONS

Disposable Receptacle Assembly



Shown with optional backshell (See Table C)

Disposable Receptacle



Select this component from Table B

Rear Panel-Mount Receptacle Assembly

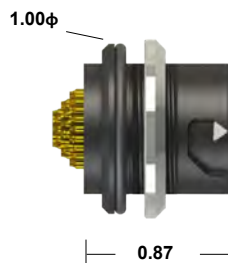

Panel Thickness Range = 0.063 to 0.250
Select this component from Table B

Cable Mount Plug Assembly



Shown with optional backshell

Cable Mount Plug Kit



Select this component from Table B

Note: Standard color configuration is black on black. See our online configurator for more color options at: www.amphenolalden.com/configurator *All dimensions shown in inches except where indicated

For additional information about this, or any other Amphenol Alden product, please contact an Amphenol Alden specialist today, www.AmphenolAlden.com

Phone: 1(508) 427-7000
E-mail: info@AmphenolAlden.com
www.AmphenolAlden.com

PL-900RG-N SERIES

Plastic Shell Auto-Coupling Connectors **52 pole capacity disposable receptacle and support interconnects**

TABLE:

STANDARD PART NUMBERS

Number of Poles	Disposable Receptacle		Rear Panel-Mount Receptacle		Cable Mount Plug
	Solder Cup	PCB	Solder Cup	PCB	Solder Cup
52	341422	342946	342512	342519	341252
41	341421	342932	342484	342491	341224
35	341420	342918	342456	342463	341196
28	341364	342904	342428	342435	341168
24 (26AWG)	341350	342890	342541	342407	341140
24 (22AWG)	341336	342876	342372	342379	341112
17	341322	342862	342344	342351	341084
15	341308	342848	342316	342323	341056
11	341294	342834	342288	342295	341028
9	341280	342820	342260	342267	341000

Note: Part numbers cover black housings in Key 1 configuration. For other color and housing options utilize the Amphenol Aiden connector configurator located at www.amphenolaiden.com/configurator

Options Include:

Indicator Color Options

Mating Key Options

Panel-Mount Thickness Options

Black (std.), Gray, White, Blue, Red, Green, Yellow

2 Standard Keys, Proprietary Keys Available

.125 (std.), .063, .187, .250

CONTACT TERMINATION OPTIONS

PCB (Panel-Mount Receptacles only)



Request Sales Drawing for PCB mounting template

Features & Benefits

- Available in most pole counts from 9 to 52 Poles
- PCB stand-offs ensure proper positioning
- Convenient packaging high temperature contact cures may be soldered to PCB and snapped into panel-mounted receptacle housing later



Features & Benefits

Tiered solder cups provide easy access to center positions. Canted cups facilitate quick and easy wire positioning. Standard on 9-52 pole configurations

Panel-Mount, Cut-Out Template

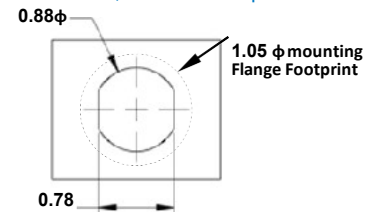

Applies to Rear Panel-Mount Receptacles

TABLE:

ACCESSORIES

Rear Panel-Mount Receptacle Dust Cover (Nylon Tether locks into panel washer)



P/N 110401-01

Cable Mount Receptacle Dust Cover (Wire Tether with cable loop)

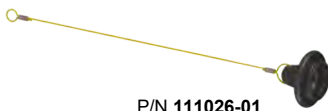

P/N 111026-01

Receptacle Dust Cover:

The PL-900 Series receptacle dust cover protects the receptacles contact system from dust, moisture, and mechanical stress when the connector pair is disengaged. When secured the dust cover will provide an IP-67 environmental seal. The cover is equipped with a tether for security.

Disposable Receptacle Backshell



(Wire exit i.d.)

Dimension A	Part Number
0.140	107307-01
0.166	107307-08
0.180	107307-15
0.210	107307-22
0.260	107307-29

Plug Backshell



(Wire exit i.d.)

Dimension A	Part Number
0.354	109353-01
0.420	109353

Plug Soaking Cap (Wire Tether with cable loop)



P/N 108717-08 (Available without tether)

Plug Soaking Cap:

The PL-900 Series Plug Soaking Cap is designed to protect the plug's contact system when a cable assembly is being cleaned or not in use. The soaking cap locks onto the plug providing an IP-67 seal that is ideal for soaking in liquid disinfectants. The soaking cap can be permanently attached to a cable assembly by means of a light weight tether.

Note: Black (std.) Gray (optional) & accessories sold separately

Assembly Instructions:

AI-PL900RGN-01 (9-52, 22&26AWG)

ASSEMBLY INSTRUCTIONS

Note: recommended tooling included in assembly instructions

For additional information about this, or any other Amphenol Aiden product, please contact an Amphenol Aiden specialist today, www.AmphenolAiden.com

Phone: 1(508) 427-7000
E-mail: info@AmphenolAiden.com
www.AmphenolAiden.com